

INSTALLATION INSTRUCTIONS

5G® Locking System

BEFORE YOU BEGIN System (go to YouTube 5G folddown installation video)

Please read all instructions carefully before you begin and check the 5G locking system guidelines. Improper installation will void the warranty. Check planks to make sure they are the correct colour and dye batch required. Check planks for defects such as gloss level difference or chips prior to installation. Check that the locking profile channel is clean and free of debris. Defective planks should not be used.

Make sure the area is a well ventilated area and the use of the correct PPE including dust masks are used during installation.

The subfloor and site conditions along with the materials shall be installed in accordance with Australian Standards 1884:2021 as well as the specifications described in these instructions. All Hybrid/Rigid Core products installed in wet areas, including bathrooms do not meet the National Construction Code (NCC) and Australian Standard 370:2021.

A perimeter expansion gap of no less than 8.00mm is required around the perimeter walls and permanent fixtures like kitchen island benches and built in furniture and the like. Skirting boards, quads or scotias can be used to cover the gap. These must not be attached to the floor, leaving a small gap between the base of the trim and the floor to allow the floor to float freely. For larger areas over 100m² a minimum 10.00mm perimeter expansion gap is required.

An expansion join trim (T moulding) must be used for any length or width exceeding 15mtrs and the maximum room/run size (raft) is 15mts in length and no more than 15mtrs in width.

In doorways and between adjoining rooms, the use of expansion joints (T Mouldings) must also be utilised to compartmentalise the flooring to allow the area in the adjoining room to expand and contract independently.

When using planks from more than one package, check the colours and patterns match before you begin. During installation, mix and match panels from each box throughout the floor. Always mix planks from at least 4 packs at any one time.

Remove skirting boards if possible. If they are difficult to remove, they may be left in place as long as the appropriate expansion gap is left, finish off with quads or scotias.

Door frames should be undercut to allow the floor to expand and contract or (move) freely.

No fillers such as silicon or caulking agents are to be used in the installation of hybrid planks as it will not allow the floor to float, expand and contract as it is designed to do.

This product is not suitable for installation in garages, patios or balconies. It is recommended for residential and light commercial applications only. As this product is a hybrid floating floor system it should not have a load greater than 180kgs. If this situation arises FDA's direct stick 2.00mm-5.00mm LVT system should be considered.

General and Environmental Advice

Large windows, glass doors and skylights which are exposed to large amounts of sun and heat can create high floor surface temperatures along with high amounts of UV exposure.

While our products are manufactured to be stable all flooring should be protected from high temperatures and direct sunlight. The use of temperature and humidity controllers, and also window treatments, window tinting, awnings and or blinds are recommended in these situations.

Dramatic temperature changes and or extreme humidity can cause joins to lip/peak or gap. Prolonged direct sunlight can cause fading.

FLOOR PREPARATION

In order to have a successful installation, all floor surfaces must be clean, dry, solid, even and level. All sub-floors must meet the minimum requirements as defined in Australian Standards AS1884-2021.

IMPORTANT: Uneven sub-floors can weaken the end joints/locking system. Any isolated highpoints/ridges should be removed in order to avoid damage and void the warranty.

Floors must be plain, flat and level to a maximum variation of 4mm over 2mtrs in any direction.

- Moisture content: concrete slabs should be checked prior to the installation commencing and should comply to AS1884-2021.
- Tiles/ceramics: must be smooth, level and firmly fixed. Loose tiles should be removed and repaired to a structurally sound condition. Grout lines should be filled with UZIN NC888 or UZIN NC650.
- Timber floors: These should conform to AS1884-2021 should be firm with no loose boards or sheets, structurally sound, joints should be sanded.
- Vinyl/cork floors: should be fixed solid.
- Carpets/vinyls/underlay/existing floating floors: should be removed before installation.

The Aragon collections are a floating floor which will need to float freely on a subfloor. So no potential friction or bonding will take place from the pad attached to the hybrid to a subfloor the installation of a 200 micron minimum thickness black builders plastic over the subfloor and tape the seams with an appropriate moisture resistant tape is to be used.



ACCLIMATISATION

- The environment where Aragon Hybrid flooring is to be installed is critically important with regard to successful installation and continued performance of the flooring products. Aragon Hybrid Flooring is intended to be installed in interior locations only. These interior locations must meet climatic and structural requirements as well the installation conforming to Australian Standard AS1884:2021
- It is best practice to acclimatise planks on site where they are to be installed at least 24hours prior to installation. The temperature must be kept between 18-27°C.
- Flooring should only be installed in temperature-controlled environments. It is necessary to maintain a constant temperature of 18-27°C before and during the installation and at least 48 hours after installation is completed. Portable heaters are not recommended as they may not heat the room and subfloor sufficiently.
- When installing in areas that are exposed to temperatures over 40C and to significant temperature fluctuations the expansion joint must be increased to 10mm, the installation on the entire periphery and from all fixtures in the room.
- Do not install kitchen cabinets / bars / built in furniture / pool tables and the like directly over your Aragon floor. Aragon quality is assured as long as the floor can move freely.

STAIR INSTALLATION

To maintain safety and product performance all stairs should be glued direct to tread and riser.

Stairs should be installed with a suitable adhesive such as Bostik Ultra-set, or an adhesive of similar structure as recommended and warranted by the adhesive manufacturer. Use of liquid nails is not recommended.

Adhesive should be applied with a 5mm notch trowel with 100% coverage of tread and riser.

Surface should be firm, flat and free from any contaminants including paint or chemical residue.

Remove the underlay from the back of the plank before installation for best adhesion.

Ensure stair nosing is fitted flush with stair tread edge.



BASIC INSTALLATION

After thoroughly cleaning the subfloor install a 200 micron minimum thickness black builders plastic over concrete slab and tape the seams with an appropriate moisture resistant tape.

1. First row, first plank: you should begin laying from left to right. Position the first plank so that grooved edge is facing you. Place the floorboard 8.00mm from the left wall. Use spacers between the wall and the floorboard.



2. First row, second plank: Place the plank gently and close to the short side of the previous plank. Fold down the plank starting from the opposite corner of the plank to the closest corner (as shown on the drawing), press down slightly along the short side of the plank just installed so it firmly locks into the previous plank until both are at the same height. Make sure both planks are perfectly aligned. It is crucial that the short edges of two connecting planks are correctly aligned, and the hand contacts the plank in the area directly above the short edge, allowing for correct locking.

Note: Pressing the area close to the short edge, but not directly above it may result in permanent damage to the joint. Continue installing the first row until you reach the wall on the opposite wall.



IMPORTANT: If you notice both planks aren't at the same height or are not well locked together, please follow the disassembling instructions at the bottom of the page, disassemble and check if any debris stuck inside the lock is obstructing. Failure to properly line up the end joint and attempting to force it in while out of alignment could result in permanent damage to the end joint. 3. First row, last plank: At the end of the first row, leave an expansion gap of 8.00mm to the wall and measure the length of the last plank to fit.

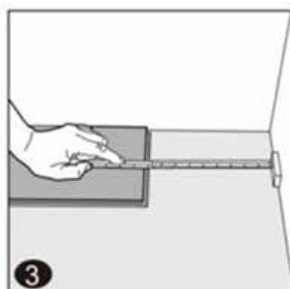

4. To cut the plank: Use a simple utility knife and ruler, and with the top side facing up, cut heavily and several times on the same axis. The knife will not go through the surface but make a deep cut. You can then lift one half of the plank using your other hand to hold down the second placing it very close to the cut. The plank will split naturally. Use a saw or guillotine on sides.



5. Second row, first plank: Start the second row with the leftover cut part of the last plank of the previous row. This small plank should measure at least 30 cm. Otherwise, cut a new plank in half and use it to begin the second row. The end joints of each adjoining row should not be closer than 20 cm to each other. Whenever practical, use the piece cut from the preceding row to start the next row.

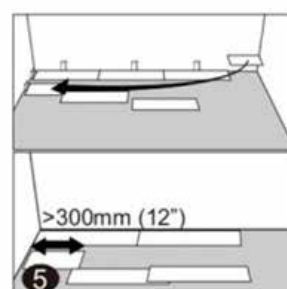

6. Second row, second plank: Click the long side of the plank into the previous row and place it tight to the short end of the previous plank with an angle of 25-30 degrees. Drop the plank and gently and using an offcut of material or an adapted tapping block, gently tap on the end with a rubber mallet and tapping block so it firmly locks into the previous plank until both are at the same height. Make sure both planks are perfectly aligned.

Place the panel gently and close to the short end of the previous panel and fold it down in a single movement.

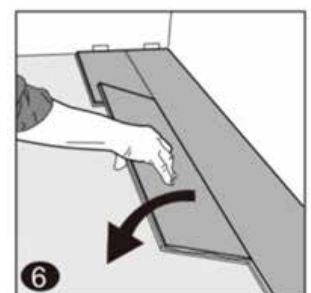

7. After finishing the installation of every row: Use scrap pieces (male on female) and a rubber mallet to gently tap the planks into the click of the previous row to make sure they are tightly clicked together and ensure there is no gap between the long side of the planks installed. Any gapping can compromise the whole installation.

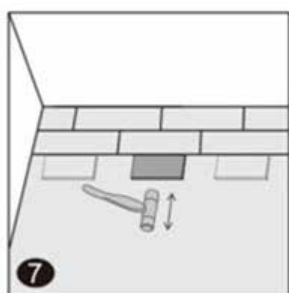

8. Tip: After the first 2-3 rows of planks are installed; they should be checked with a string line to ensure that rows are still running straight. If they are not, it could be that the starting wall has some irregularities that caused bowing in the installation. If so, the starting row of planks may have to be scribed and re-trimmed to account for any unevenness in the wall. This can be done without having to disassemble the beginning rows.

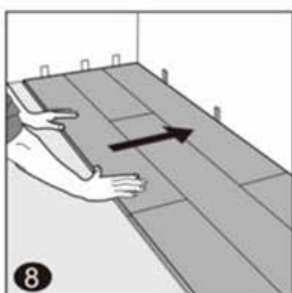

9. To lay the last row: Position a loose board exactly on top of the last row laid. Place another board on top, with the tongue side touching the wall. Draw a line along the edge of this board, to mark the first board. Cut along the edge of this board to mark the first board. Cut along this line to obtain the required width. Insert this cut board against the wall. The last row should be at least 50mm wide. The spacers can then be removed.

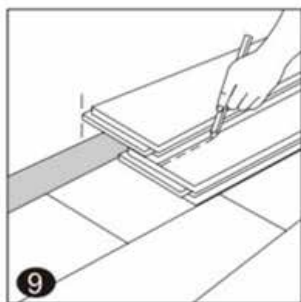

10. Holes for pipes: Measure the diameter of the pipe and drill a hole that is 12mm larger. Saw off a piece as shown in the figure and lay the board in place on the floor. Then lay the sawed-off piece in place.

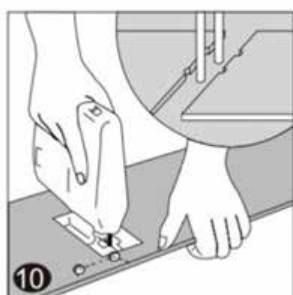

11. Door molding and skirting: Lay a board (with the decorative side down) next to the door moulding and saw as shown in the figure. Then slide the floorboard under molding.



FINISHING THE INSTALLATION -

Replace molding or wall base, allowing slight clearance between the molding and the planks. Nail the molding to the wall surface, not through the flooring. At doorways and at other areas where the flooring planks may meet other flooring surfaces, it is preferable to use a "T" moulding, or similar, to cover the exposed edge but not pinch the planks. Leave a 8.00mm gap between the planks and the adjoining surface.

Note: Skirting/molding should not be forced down on top of flooring under any circumstances. This can cause a pinching affect, restricting product movement and voiding the warranty. • Scotia and skirting should be fixed to the wall, not be fixed to flooring. • Silicone/sealant should not be used to seal or conceal gaps. This can cause a pinching effect restricting product movement and void warranty.

DISASSEMBLING -

Separate the whole row by lifting it up delicately at an angle. To separate the planks, leave them flat on the ground and slide them apart. If planks do not separate easily, you can slightly lift the planks (5°) when sliding them apart.



For product questions, please contact the flooring dealer where you made your purchase.

* ASTM standards require installation in range 18-27°C.

** Where the flooring run exceeds 15m in width or length, a 8mm expansion joint should be used and repeated thereafter.

CARE & MAINTENANCE

Our Aragon Hybrid Collections are designed to stand up to the toughest household conditions. To keep it looking its best, follow these simple instructions for care and maintenance.

To protect the surface more efficiently and keep your floor looking like new, protect the surface with a suitable PH neutral wash and shine product such as LONG LIFE*. This product requires no rinsing after application.

Do not use abrasive cleaners, bleach or wax to maintain the floor.

Scuff marks, various types of shoe soles may cause scuff marks. If scuff marks appear, we recommend you identify the cause eg. joggers/runners and remove. No claims will be accepted for scuff marks.

Avoid surface scratches by sweeping or vacuuming your floor as often as necessary to remove loose dirt. Weekly maintenance should be carried out by washing the floor with water and a suitable vinyl floor cleaner*

Never use steam mops on your floor. Use a damp mop only and avoid excessive amounts of water.

Furniture pads should be used underneath all items of furniture to protect your new floor from scratches and the chance of indentations. Heavy objects exceeding 180kg should not be placed on this floating floor.

Use entrance mats to protect against grit and moisture. Protective mats should also be used under furniture or chairs with castors/wheels. Ensure they are of non-staining variety (not rubber backed) to prevent any discolouration of your floor.

Do not drag or slide heavy objects across the floor. No claims will be accepted for scratching.

